



# Instructions

## M.A.S.S. SPARE TIRE PLATFORM (STP)

Thank you for purchasing the M.A.S.S. Spare Tire Platform from AAL! We greatly appreciate your trust in our company. We take that purchase and your commitment to us very seriously. If you have any questions along the way, please don't hesitate to give us a call at 385.202.4188.

Please read the instructions thoroughly before starting this project.

### **Tools Required:**

There is more than one tool for every job, but below is the list of tools we use for this installation.

- 1/4" or 3/8" Drive Ratchet
- 4mm Allen Socket or Wrench
- 10mm Socket or Wrench

### **Identify Main Components**

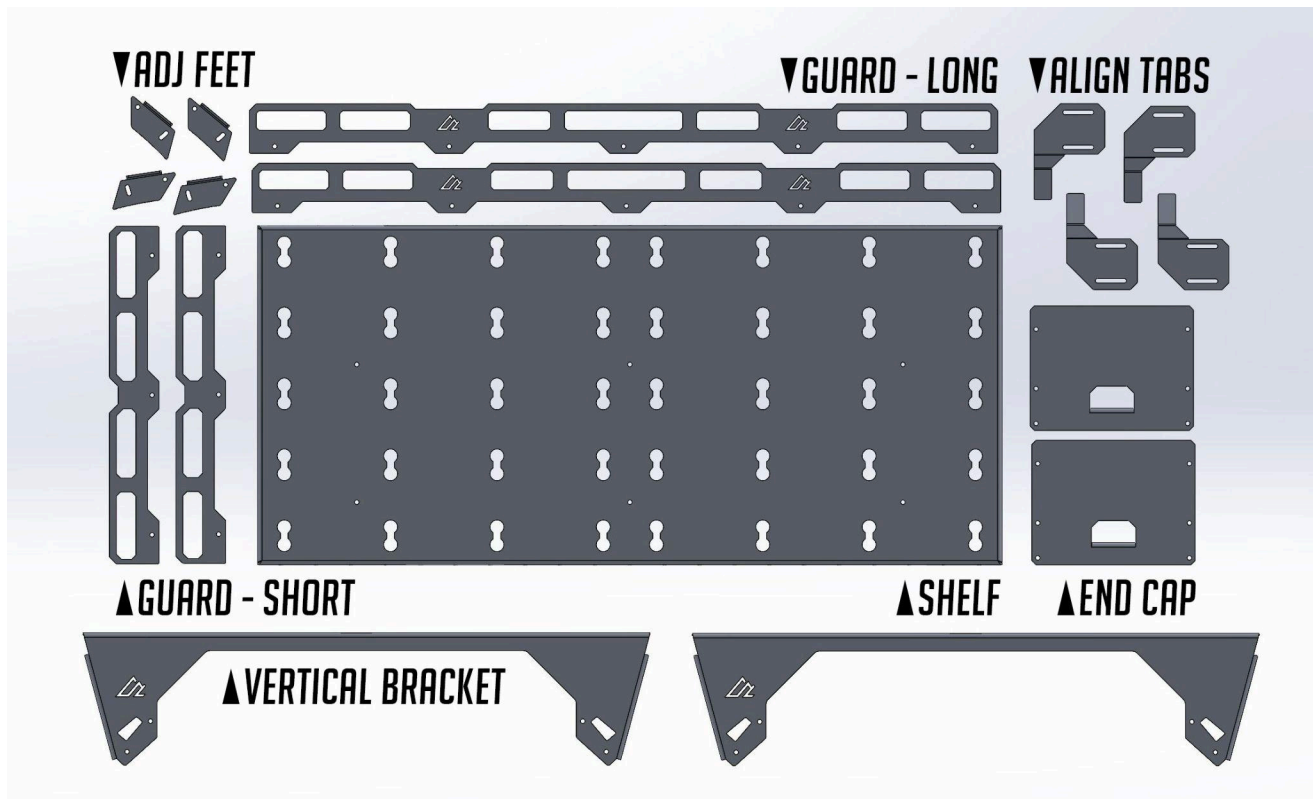

## Identify Hardware



### Step 1: Install Vertical Brackets

Install both vertical brackets with the flanges on the vertical brackets positioned to the inside as pictured below. **Loosely** attach the vertical brackets to the main platform with three 6mm X 14mm bolts (the ones without the flange) and three 6mm locknuts. The flanges on the main platform should be positioned downward.

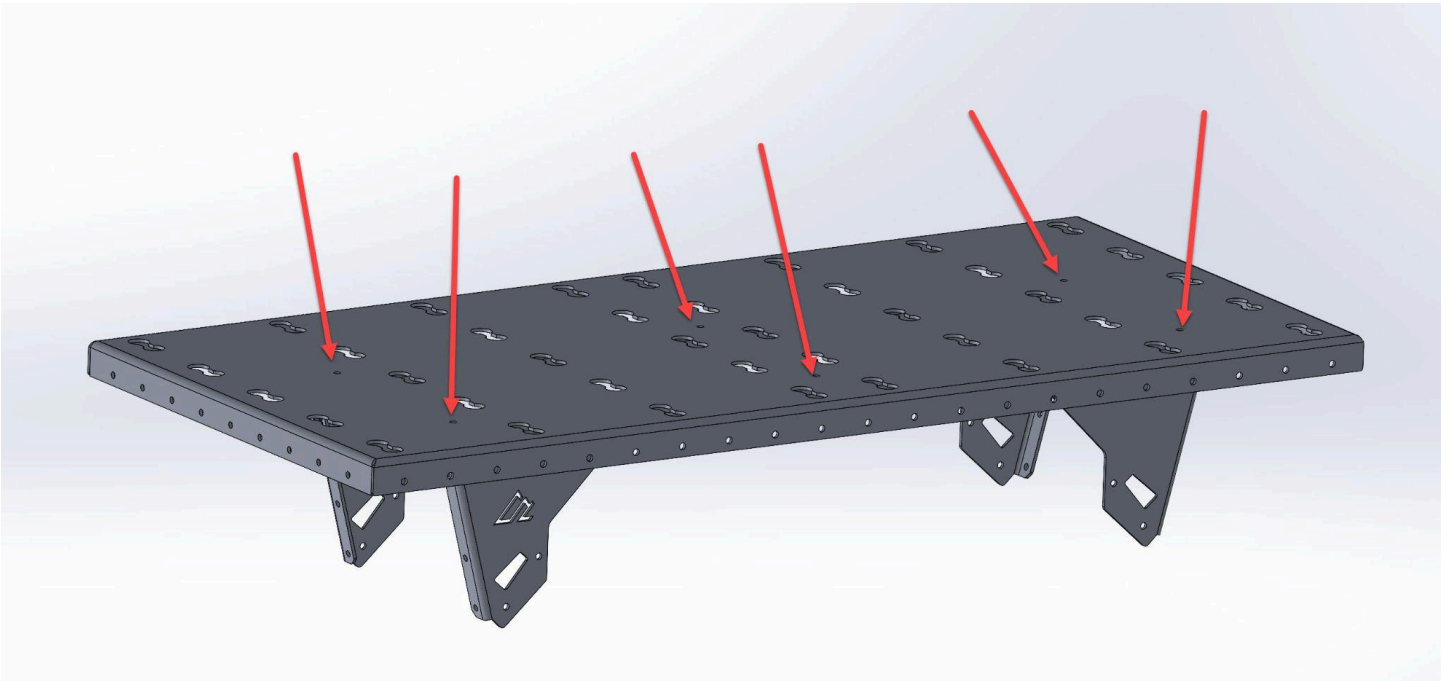

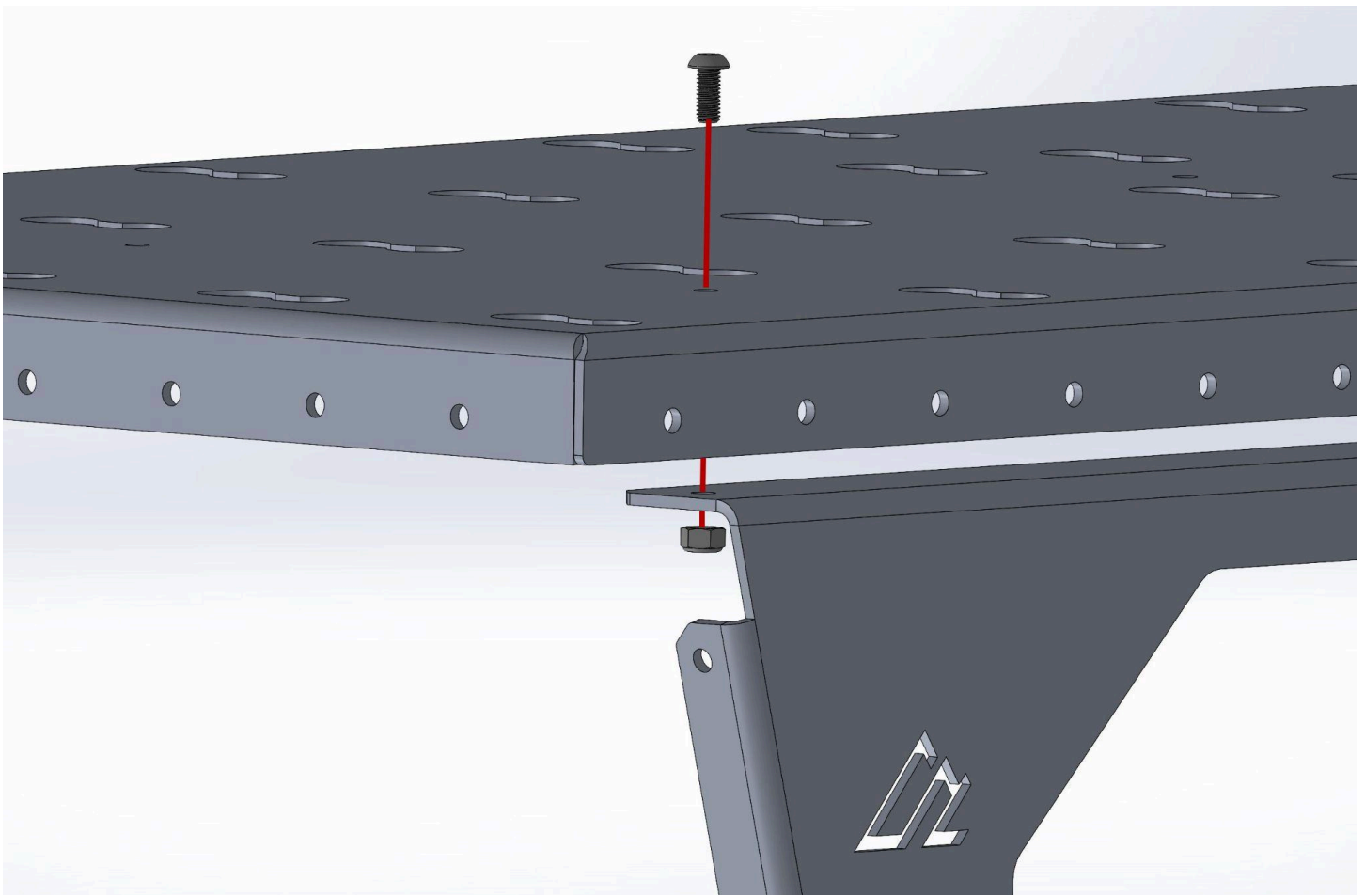

After both vertical brackets are loosely installed, here's what it should look like.

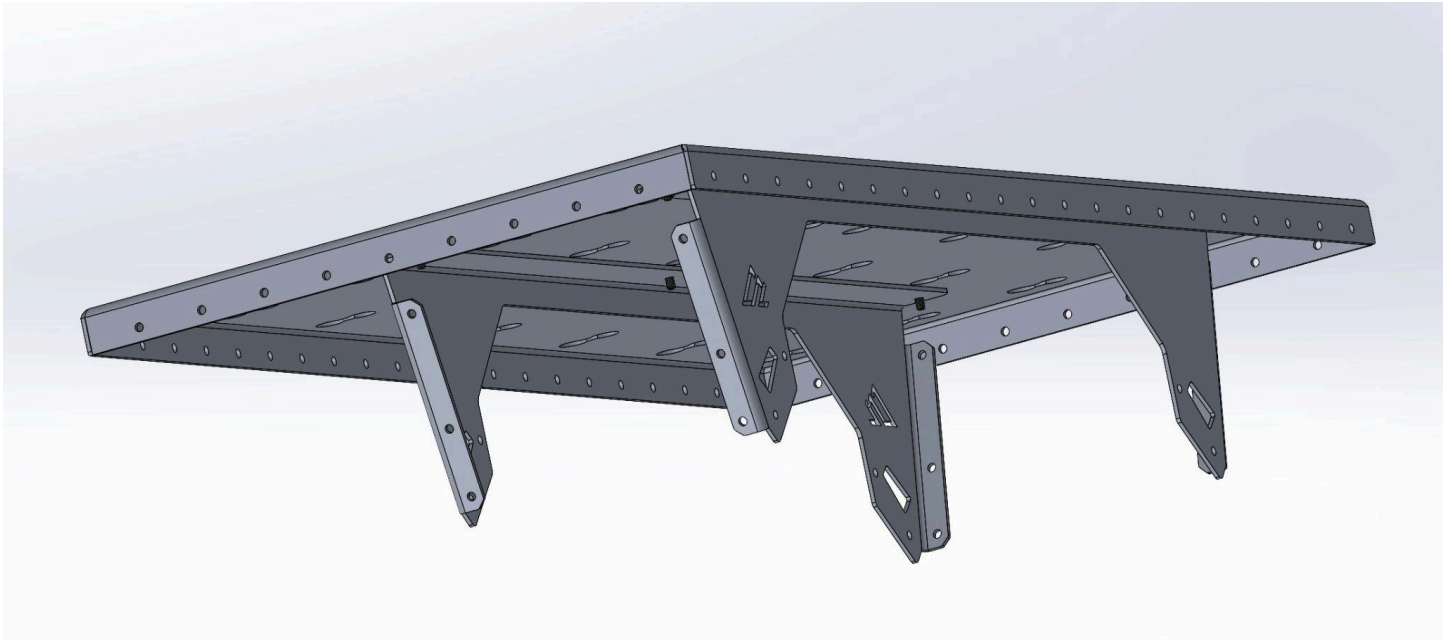

## **Step 2 - Install End Caps**

Position the end caps with the flange positioned to the inside as shown below. Use (2) 6mm x 14mm bolts (the ones without the flange head) to secure each cap to the assembly using the two upper holes in each end cap. Remember to keep these bolts loose for now.

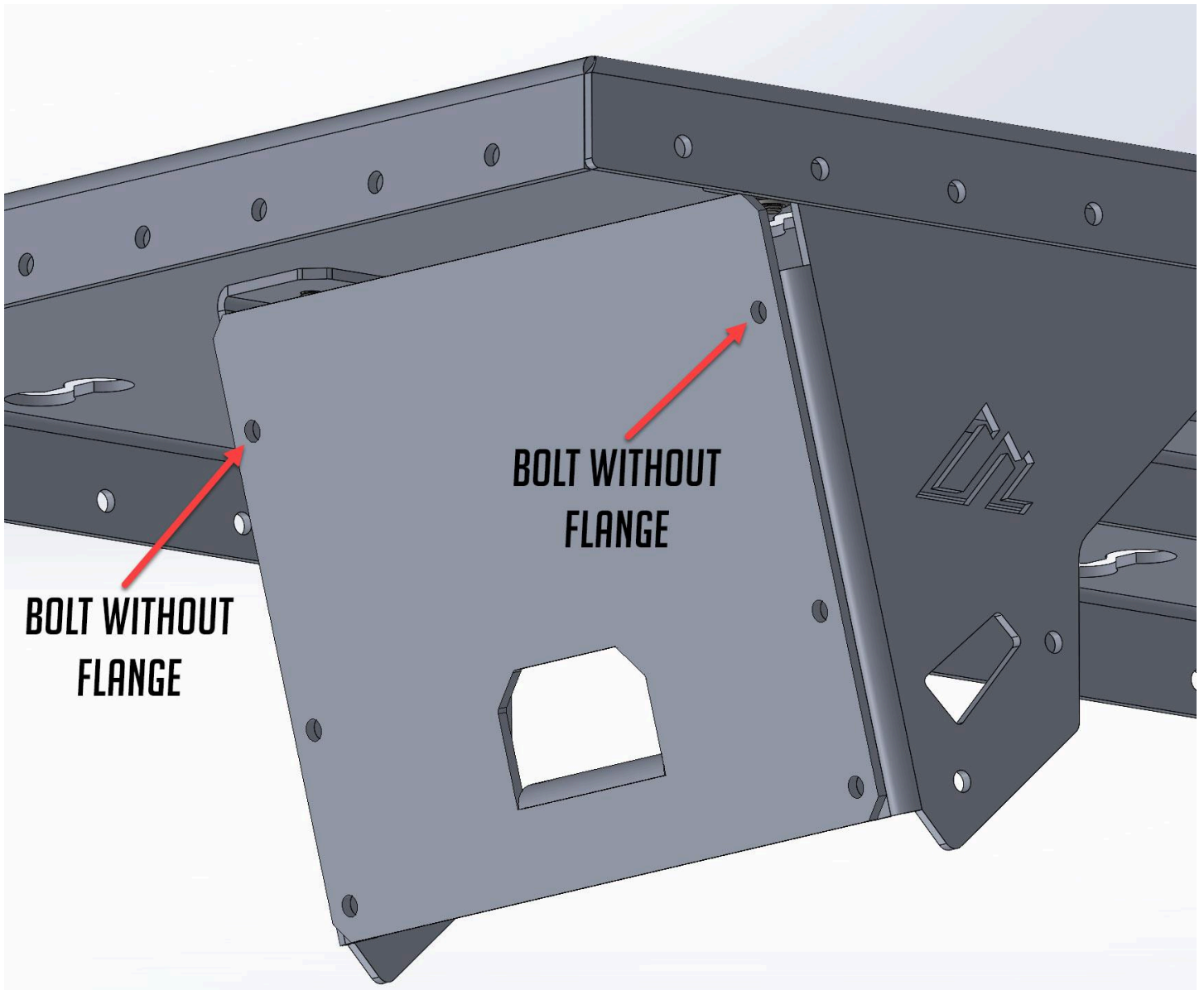

Then, using (4) 6mm x 20mm flange head bolts, secure the alignment tabs to the end caps as shown below. Be careful to position the flanges on the alignment tabs as they are shown in the diagram below.

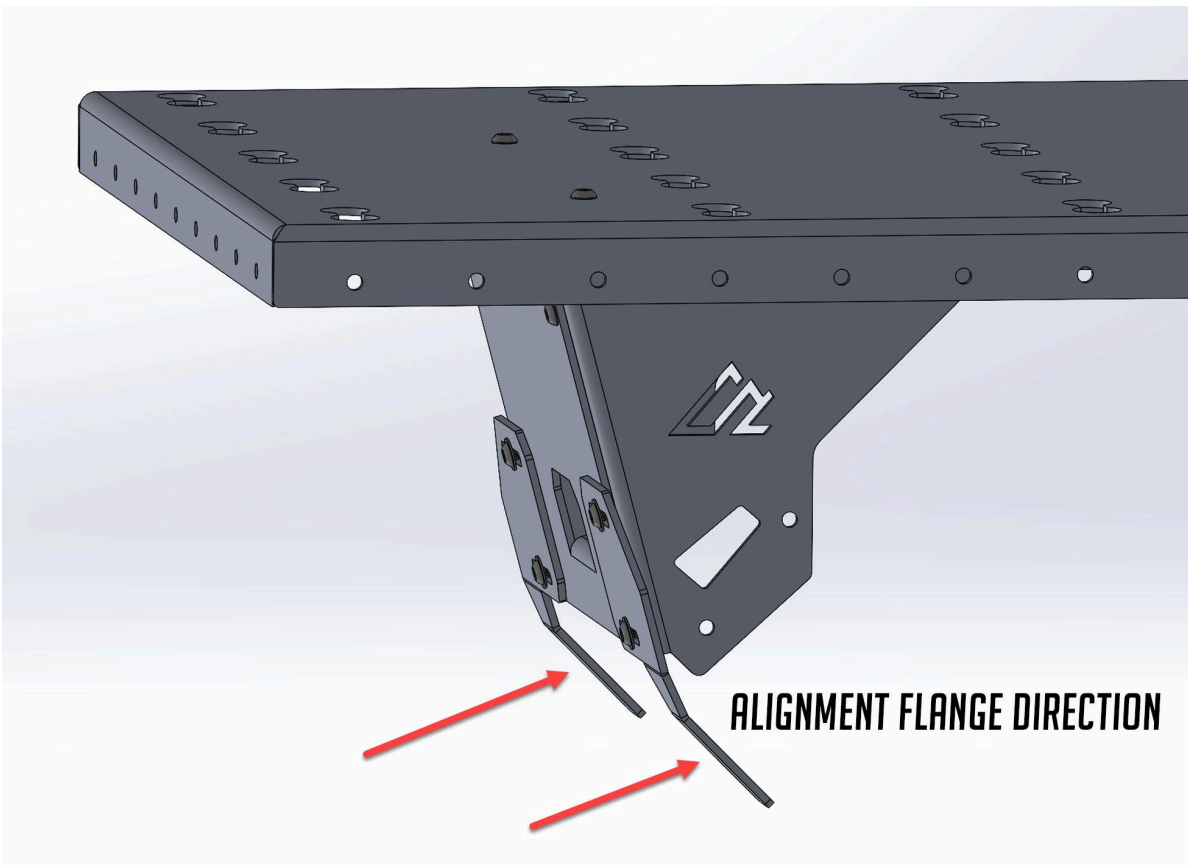

Insert the bolts as shown below.

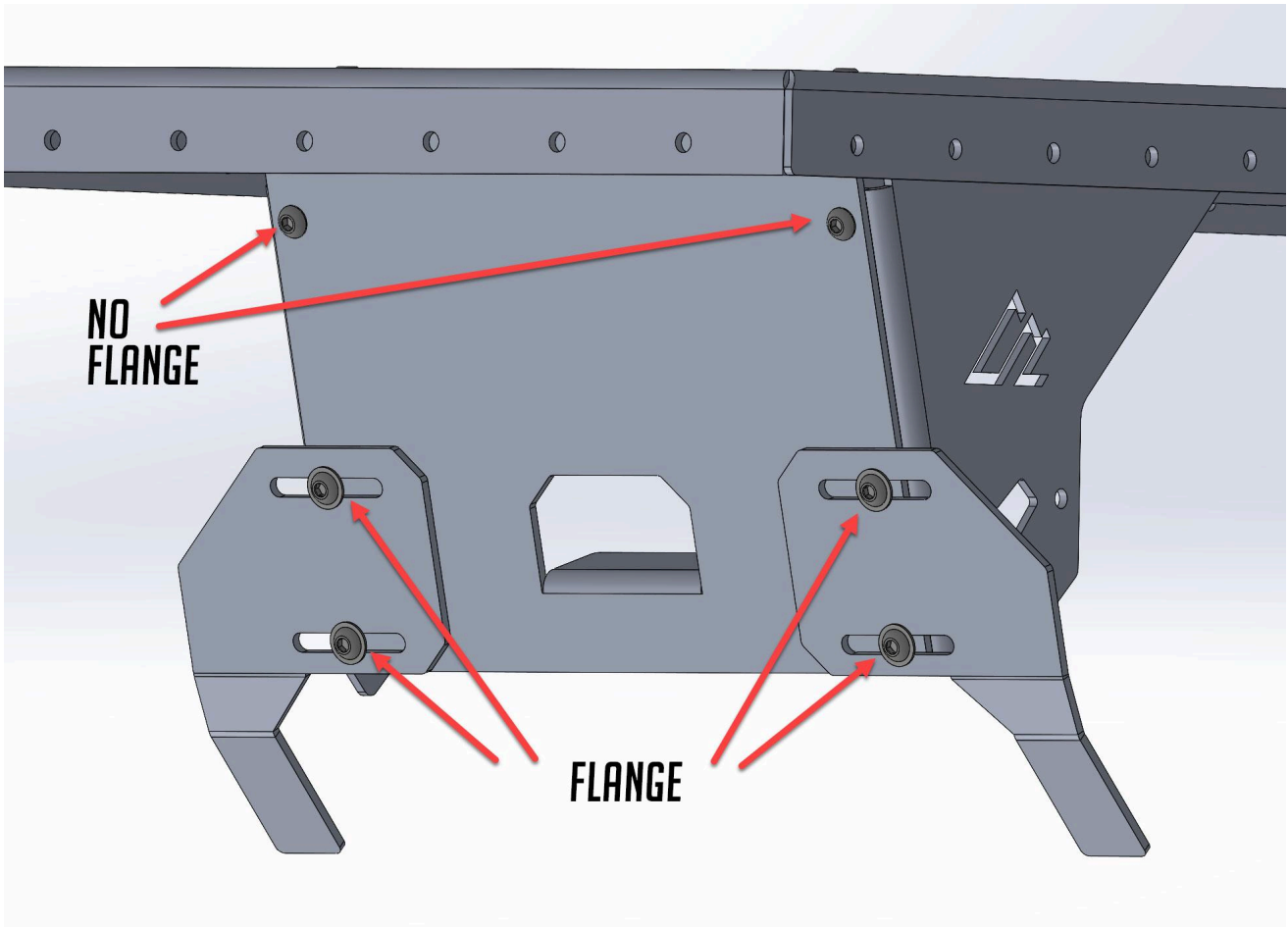

### **Step 3 - Install Adjustable Feet**

Install the adjustable feet using (2) 6mm x 14mm bolts and (2) 6mm locknuts for each foot as shown below. You have four feet. There are two different parts that are mirrors of each other. They should be installed so that the bottom of the foot aligns with the bottom of the vertical bracket and the flange bends to the inside, as shown below. Each foot will pivot to allow fitment to various tire sizes.

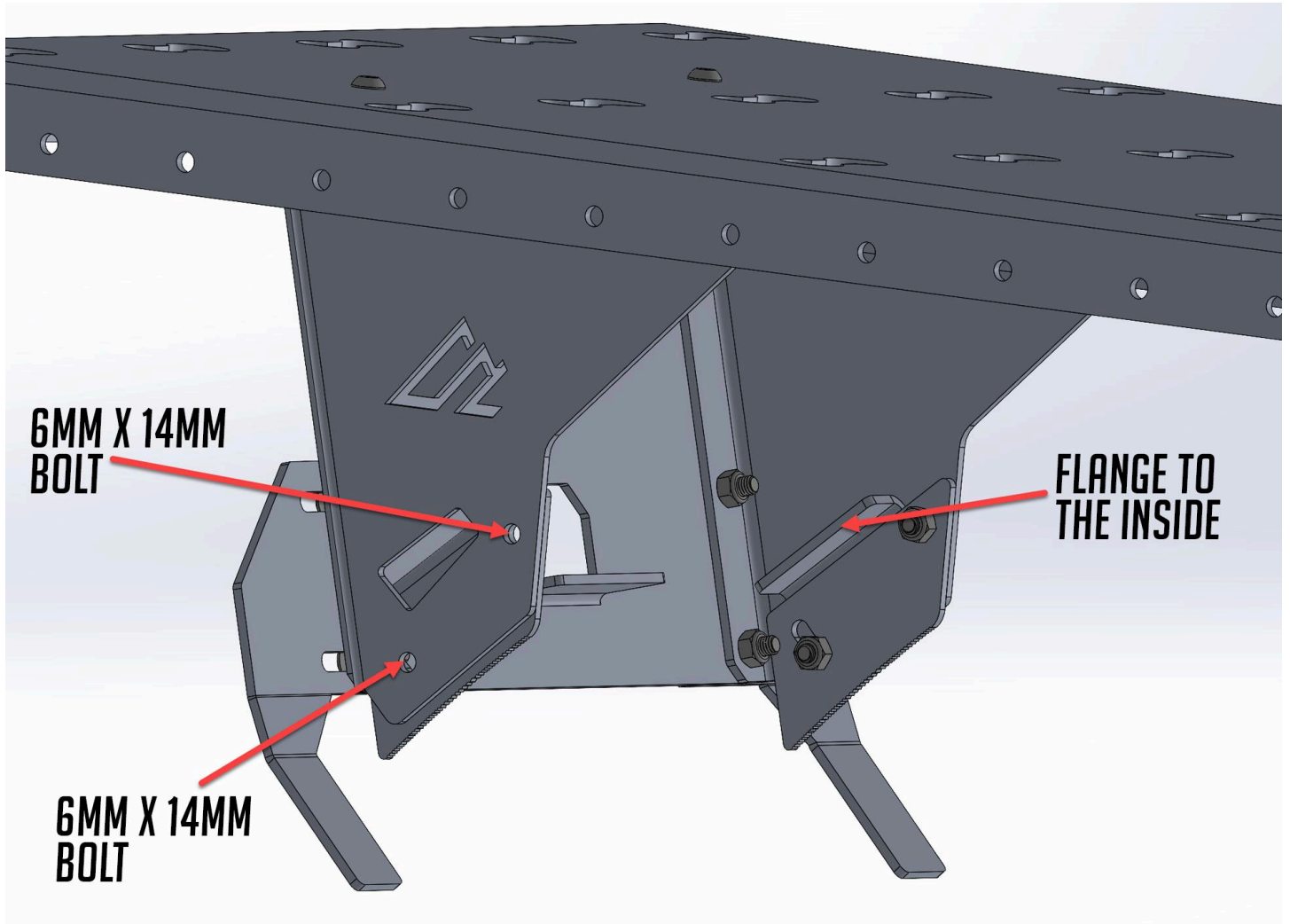

### **Step 4 - Install Edge Guards**

Using (16) 6mm x 14mm bolts and locknuts, install the edge guards as shown below. These bolts can be fully tightened now.

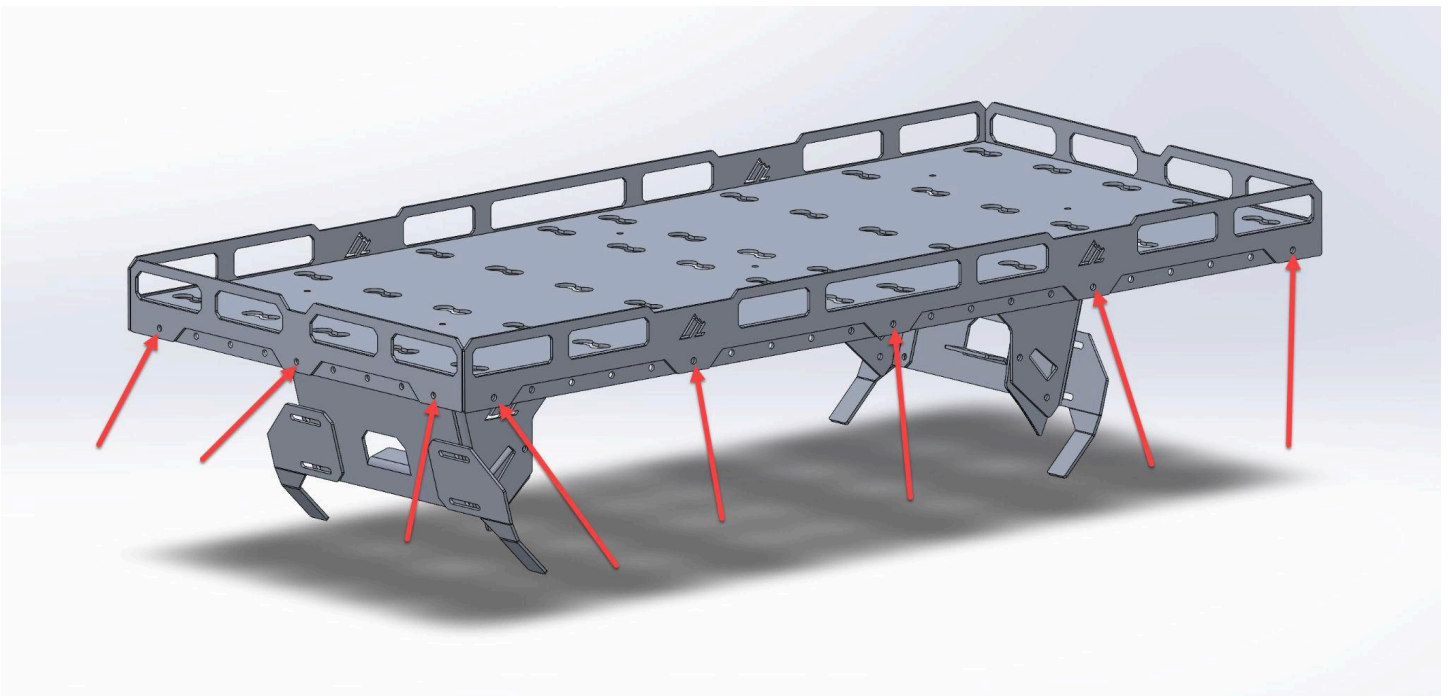

### **Step 5 - Tighten All (well, most) of the Bolts**

Tighten all of the bolts except the (8) flange bolts and the bolts for the adjustable feet. These will be adjusted in an upcoming step.

### **Step 6 - Attach to the Tire**

Notice the vertical brackets are not centered below the main platform. This allows you to choose whether you want the platform offset to the rear of the tire or the front of the tire. This will depend on your needs and the design of your tire carrier. Either way works well.

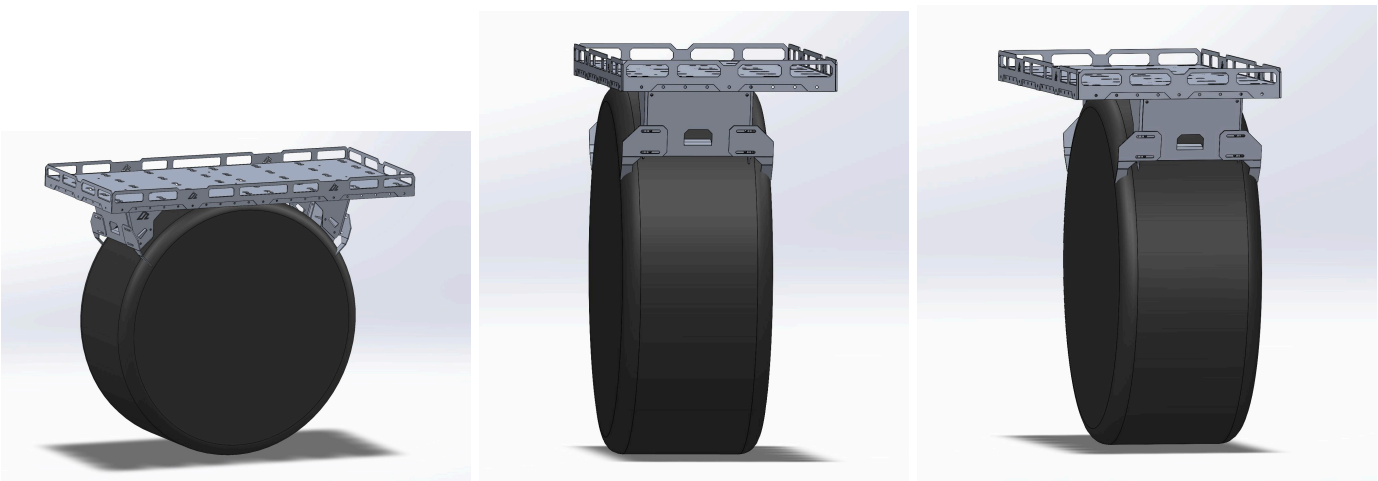

Center the vertical brackets on the tire (front to rear) and ensure that the main platform is level.

Then, adjust the feet and alignment tabs to ensure they are making solid contact with the tire.

Next, after checking for level and center alignment, tighten the bolts for the alignment tabs and adjustable feet.

Finally, secure the platform to the tire using ratchet straps. If you purchased our attachment strap kit (P/N MACS-1211), you can loop the strap through the slots in the platform (see arrows below), through the wheel, and finally back through the provided ratchet. Ensure that the strap goes through the strap slots to the front of the vehicle as well. Once both straps are connected, check for alignment and level once more and tighten the ratchets.

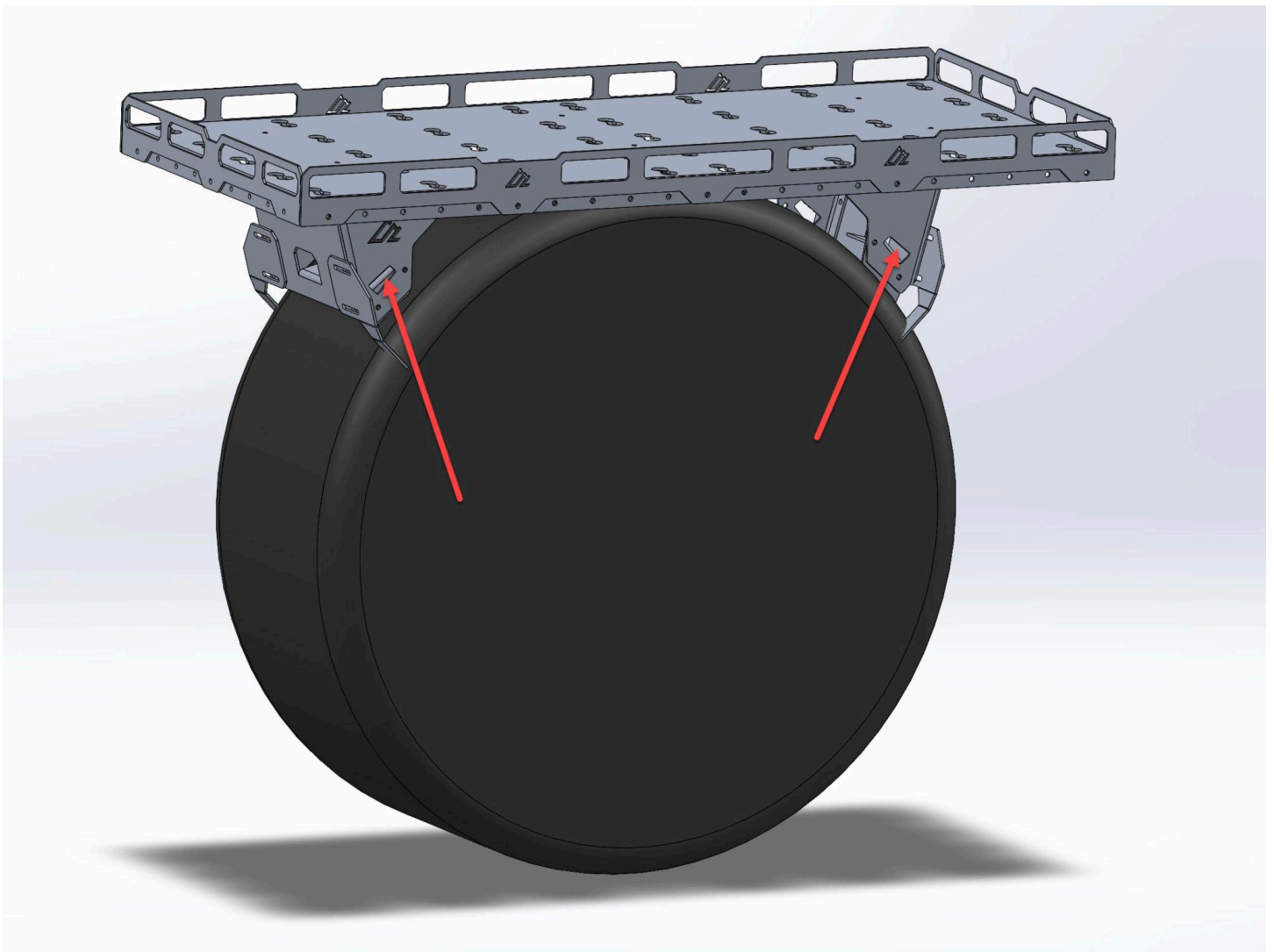

Ensure that the straps go all the way through the platform and then through the wheel. The red line below illustrates the path for the straps.



## SIDE VIEW

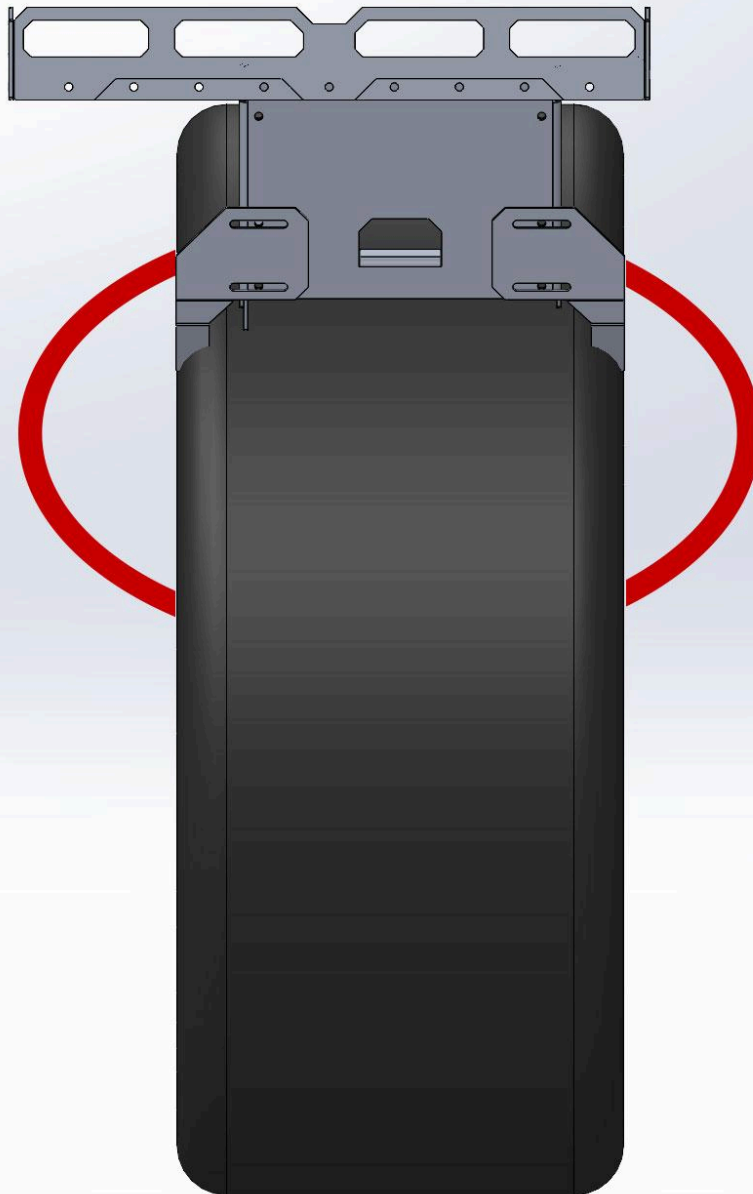

### **Step 7 - Trim and Tighten the Straps**

The last step is to fully tighten the straps. Depending on your tire size, you may be able to trim the straps and Cordura sleeves to prevent extra strap material from needing to be secured.

Before final tightening, if you purchased our strap kit, ensure that the Cordura sleeves are positioned anywhere the strap comes into contact with the wheel.

After a few miles, you should check the tightness of the straps again. It's possible for the platform to settle slightly into the tread, depending on your tires.

## **Step 8: Share Your Photos**

We take great pride in building our products and we hope that pride extends to you after installing your Spare Tire Platform. If you are able to share your photos online (Facebook and Instagram), please tag **@AmericanAdventureLab** in the photo. We would love to see how it turned out and give you some reciprocal attention in return.

**Congrats! You're all done!**

**Thank you!**

At American Adventure Lab, we strive to improve anywhere we can. If you experience any issues with this product or have any suggestions, please let us know.

If you have any questions or concerns, please don't hesitate to reach out to us at 385.202.4188 or via email at [Support@erp.Adventurelab.com](mailto:Support@erp.Adventurelab.com).

